

# Technical data sheet

90° vertical bend, rising, 35 FT

Item number: 7007176

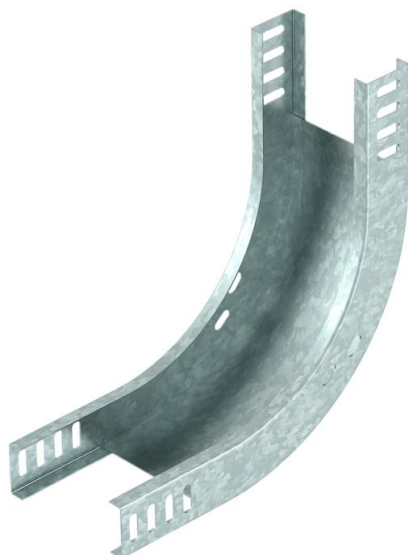

90° rising vertical bend, for all cable tray types of 35 mm side height.

The vertical bend is pushed over the end of the cable tray and screwed tight. Fastening materials should be ordered separately.



**St** Steel

**FT** Hot-dip galvanised

## Master data

Item number	7007176
Type	RBV 310 S FT
Description 1	90° vertical bend
Description 2	rising
Manufacturer	OBO
Dimension	35x100
Material	Steel
Surface	Hot-dip galvanised
Surface standard	DIN EN ISO 1461
Smallest sales unit	1
Unit of quantity	Piece
Weight	61.1 kg
Weight unit	kg/100 pc.

# Technical data sheet

90° vertical bend, rising, 35 FT

Item number: 7007176



## Dimensions

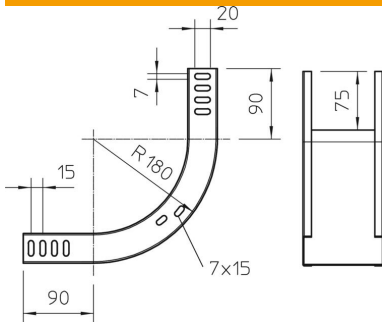

Width	100 mm
Width	4 in
Height	35 mm
Height	1 in
Plate thickness	1 mm

## Technical data

Bend (angle)	90°
Connector version	Without connectors
Change of direction	Vertical rising
Type of connector, cable support system	Screwed