

Technical data sheet

PYROLINE® Con S PLC fire protection duct EI30 - EI60



Item number: 7217864



Fire protection duct made of water and frost-resistant fibreglass lightweight concrete of material class A1 according to EN 13501-1 for fireproof routing of cables in escape and rescue routes. EI30 - EI60 classification as installation duct according to EN 13501-2 on the basis of tests in accordance with EN 1366-5. When there is an internal fire load (cable fire), the duct prevents the spread of fire from one fire section to another.

Mounting of the duct on wall brackets or as ceiling mounting with suspended supports and brackets or on a U transverse profile suspended with threaded rods. Mounted connectors ensure quick mounting in situ, whilst loosely placed covers ensure quick inspection and reassignment.

Including connection screws and sealing strips.
Including connection screws and sealing strips.



Fibreglass lightweight concrete

Master data

Item number	7217864
Type	PLCS D061220
Description 1	Fire protection duct EI60
Description 2	Suspended mounting
Manufacturer	OBO
Dimension	1000x200x120
Colour	Grey
Material	Fibreglass lightweight concrete
Smallest sales unit	1
Unit of quantity	Metre
Weight	1990 kg
Weight unit	kg/100 m

Technical data sheet

PYROLINE® Con S PLC fire protection duct EI30 - EI60

Item number: 7217864



Dimensions

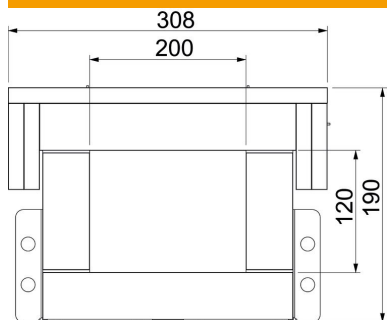

Length	1,000 mm
Dimension B	308 mm
Dimension b	200 mm
Dimension h	120 mm
Dimension H	190 mm

Technical data

Number of flammable sides	4
Cover fastening	Loose
Classification EI - installation duct	60
With perforation	no
Jacketing	Without
Material of the insulation	Glass-fibre lightweight concrete