

Technical data sheet

Head plate for welding

Item number: 6347088



Head plate for welding to building structures. In combination with the IS 8 support, suspended supports of any length can be created in situ. The maximum length of the support is 2,000 mm.

The head plate can be mounted to fixed lengths of the I support, type IS 8. The head plate is fixed to the support using two truss-head bolts, type FRS M10 x 25, which must be ordered separately.



St Steel

FT Hot-dip galvanised

Master data

Item number	6347088
Type	KI 8 AOX FT
Description 1	Head plate
Description 2	for IS 8 support for welding
Manufacturer	OBO
Dimension	100mm
Material	Steel
Surface	Hot-dip galvanised
Surface standard	DIN EN ISO 1461
Smallest sales unit	1
Unit of quantity	Piece
Weight	84 kg
Weight unit	kg/100 pc.

Technical data sheet

Head plate for welding

Item number: 6347088



Dimensions

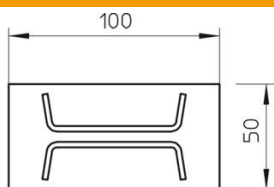

Length	100 mm
Width	50 mm
Height	150 mm

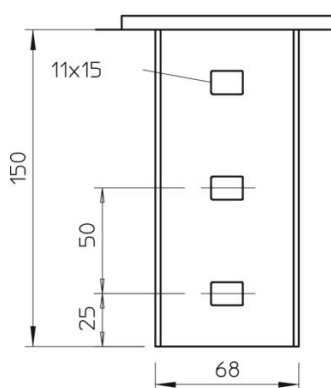

Technical data

Version for	Screw head plate
Suitable for ceiling fastening	yes
Suitable for panel fastening	no
Suitable for profile shapes	I profile
Rustproof steel, pickled	no
Angle range, max.	90 mm
Angle range, min.	90 mm