

Technical data sheet

Threaded sleeve for heavy-duty frame cassette

Item number: 7406860



Threaded sleeves for retro-installation in heavy-duty frame cassettes.



A2 Stainless steel

Master data

| | |
|---------------------|-------------------------------|
| Item number | 7406860 |
| Type | GH RK SL25 |
| Description 1 | Threaded sleeve |
| Description 2 | for heavy-duty frame cassette |
| Manufacturer | OBO |
| Dimension | L=19,0 |
| Material | Stainless steel |
| Smallest sales unit | 1 |
| Unit of quantity | Piece |
| Weight | 1.474 kg |
| Weight unit | kg/100 pc. |

Technical data sheet

Threaded sleeve for heavy-duty frame cassette

Item number: 7406860



Dimensions

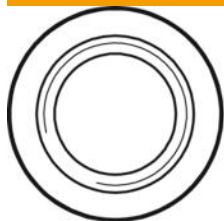

| | |
|-------------|-------|
| Length | 19 mm |
| Dimension L | 19 mm |

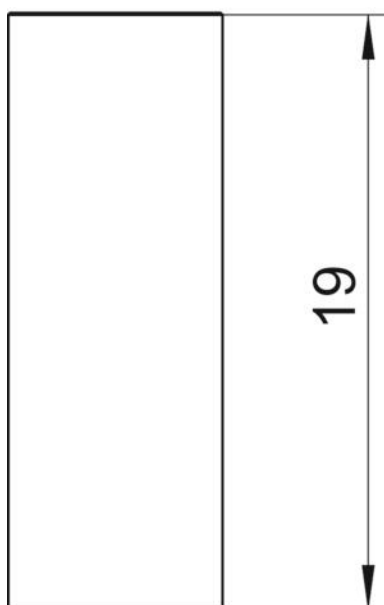

Technical data

| | |
|--------------------------|-------|
| Floor covering thickness | 19 mm |
|--------------------------|-------|